



expé



NOMENCLATURE

Entretoises
D10 L7.5  x4

Visserie
M5 L20  x12
M5 L6  x8*

(g) Cintrage x2

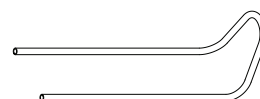

(a) Platine supérieure x4



Passage de vis

(b) Platine inférieure x4



Fillet M5

(c) Pression_indB x8*



(d) Attache x4



*Les illustrations qui suivent présentent l'ancienne version de la pièce Pression. Les anciennes vis M5 L8 CHC sont remplacées par des vis sans tête M5 L6. Le montage reste identique.

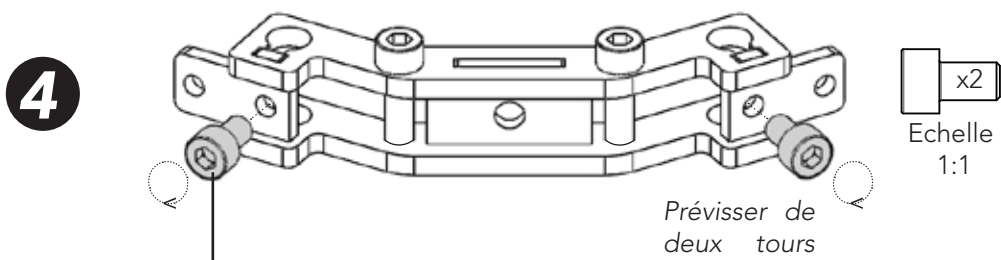
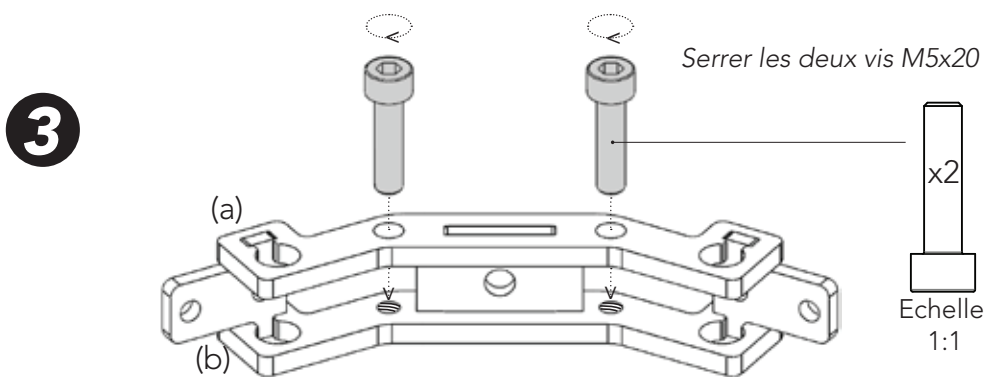
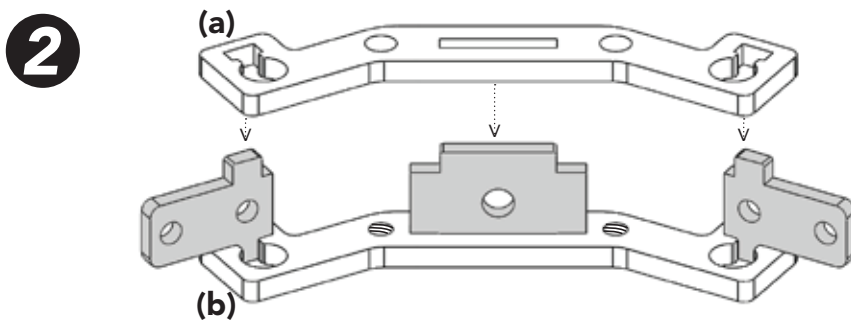
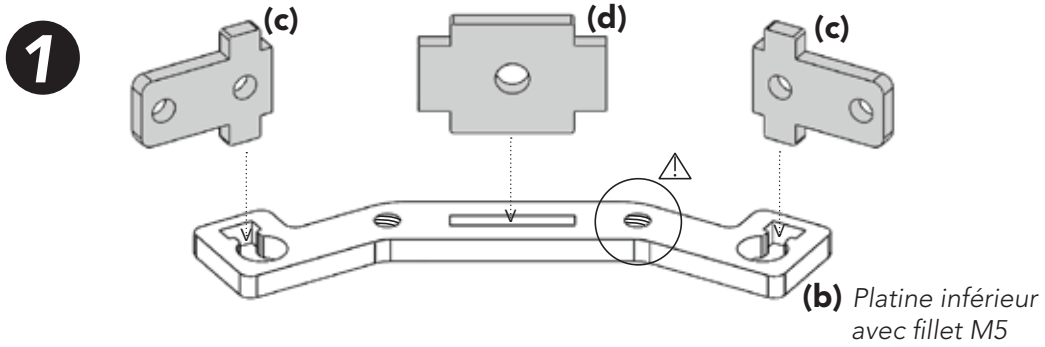

Les anciennes vis M5 L8 CHC sont remplacées par des vis sans tête M5 L6

5

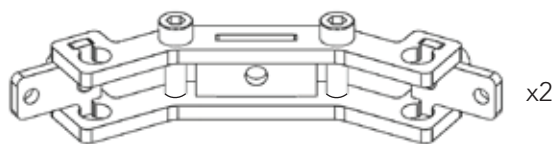

Répéter les étapes 1 à 4

6

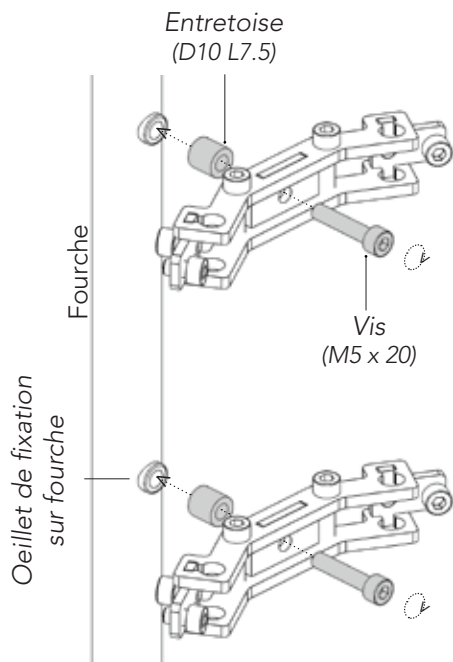

7

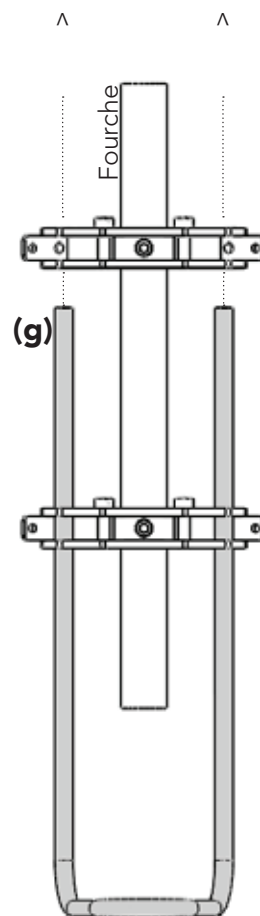

8

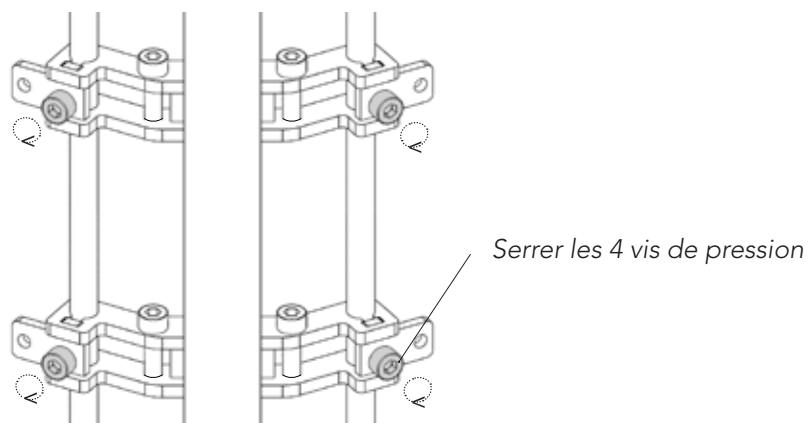

9

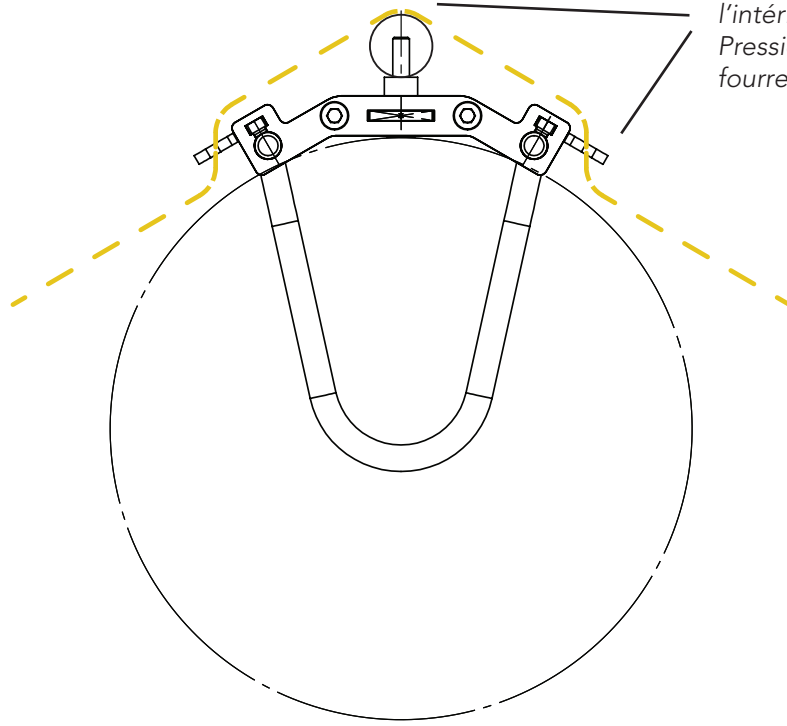

Installer les sangles, en passant à l'intérieur de la boucle des pièces Pression_indB, et par l'arrière des fourreaux de votre fourche

